

PressureStream Powered Ventilator



MoffittCorp.com | (800) 474-3267
1351 13th Ave S. Suite 130
Jacksonville Beach, FL 32250



PressureStream Powered Ventilator

PressureStream Table of Contents

PressureStream Table of Contents	2
PressureStream Product Details	3
PressureStream Roof Mount Submittal Data	4
PressureStream Wall Mount Submittal Data.....	5

PressureStream Powered Ventilator

PressureStream Product Details

PRODUCT DESCRIPTION

The PressureStream is a multi-functional, modular fan system designed to work in several different design applications. The base PressureStream is designed with a 3 or 5 HP, 1160rpm, TEFC motor with wall housing fabricated from mill finish aluminum. It has a fan airfoil impeller fabricated from Fiber-reinforced thermoplastic with sound level of 72dba @ 5'. It is designed to be used in both Industrial and Commercial applications.

Each unit can mounted horizontally or vertically, for either exhaust or supply air. The PressureStream is the key component in a Moffitt Pressure Gravity System® and the perfect mate to Moffitt natural ventilation products. The propeller hubs are made from high-strength die cast aluminum and the housings are manufactured of aluminum. Automatic dampers close when the units are not in use. PressureStream fans ship factory assembled for quick installation.

STANDARD FEATURES

- Fan Diameter: 36"
- CFM: 20,000
- Direct drive motor, variable pitch
- Fiber reinforced thermoplastic blades with helical twist and airfoil shape.
- High-strength die-cast aluminum propeller hubs
- Housings: Aluminum
- 3 HP, 1160 RPM 230/460/3
- Intake or Exhaust applications
- Suitable for sidewall or roof mounting
 - Roof Mount:
 - Hood OD: 88"
 - Curb OD: 46"
 - Average Weight: 800 lbs.
 - Hinged Hood for easy Access
 - Wall Mount:
 - Housing Depth: 44"
 - Housing OD: 42.5"
 - Average Weight: 450 lbs.
- 1 Year Fan and Motor Warranty
- Bird screen: ½" mesh, 19 ga. galvanized steel
- Airflow performance modeled

OPTIONAL FEATURES

- Insulated Hood
- Safety Guard Basket
- Hood Tie Downs
- 100 MPH Wind Resistant Hood for high tall roofs and high wind areas
- Auto Back Draft Damper
- HD Center Pivoted Damper w/ 115v/1 motor
- Removable Panel for Easy Damper Access
- Delay switch
- Transformer (208/230/460)
- Curb Cap Adaptor Max 4" + or -
- Disconnect Switch
- Coatings
 - Epoxy
 - Heresite®
 - Coal Tar
- Roof Curbs
- 3 HP, 1160 RPM 230/460/3
- Explosion Proof motor

PRODUCT BENEFITS

- Zero Maintenance
- Cold Weather protection damper is default
- Low-profile design imparts minimal wind load on building

INDUSTRY APPLICATIONS

- Aluminum
- Glass & Glass Products
- Power Stations

PressureStream Powered Ventilator

PressureStream Roof Mount Submittal Data

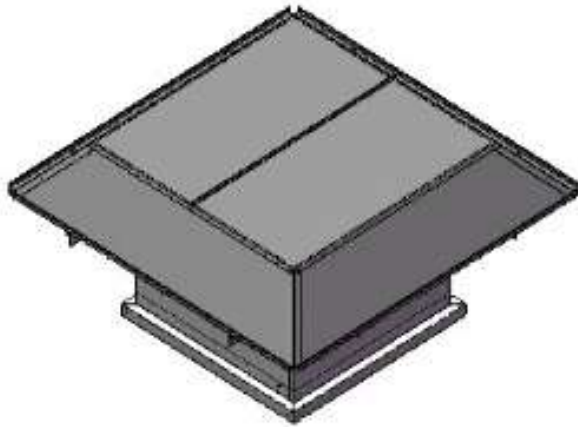

Roof Supply

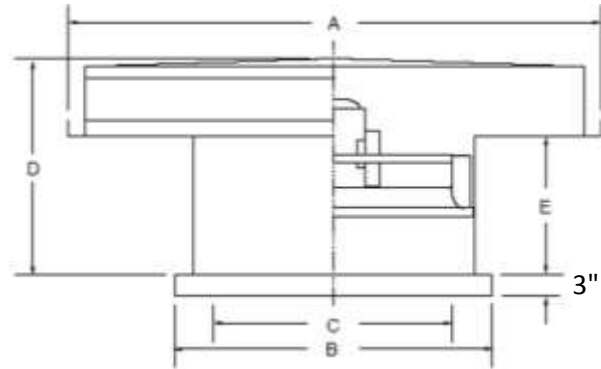

Roof Exhaust

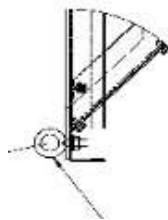

Size	A SQ O.D. Hood (2)	B I.D. Curb Cap	C Min I.D. Opening	D Height	E Stack	Prefab Curb O.D.	Metal Gauges (1)			Avg. WT.
							Crown/ Side Hood	Stack	Curb Cap	
36"	78	47	42	44	23	45 ¼	18/18	18	14	700

Notes:

- All materials are aluminum
- Dampers mount on accessory flanges inside curbs or in the duct due to space restrictions

All specifications are subject to change without notice unless approved in submittal by Moffitt

PressureStream Powered Ventilator

PressureStream Wall Mount Submittal Data

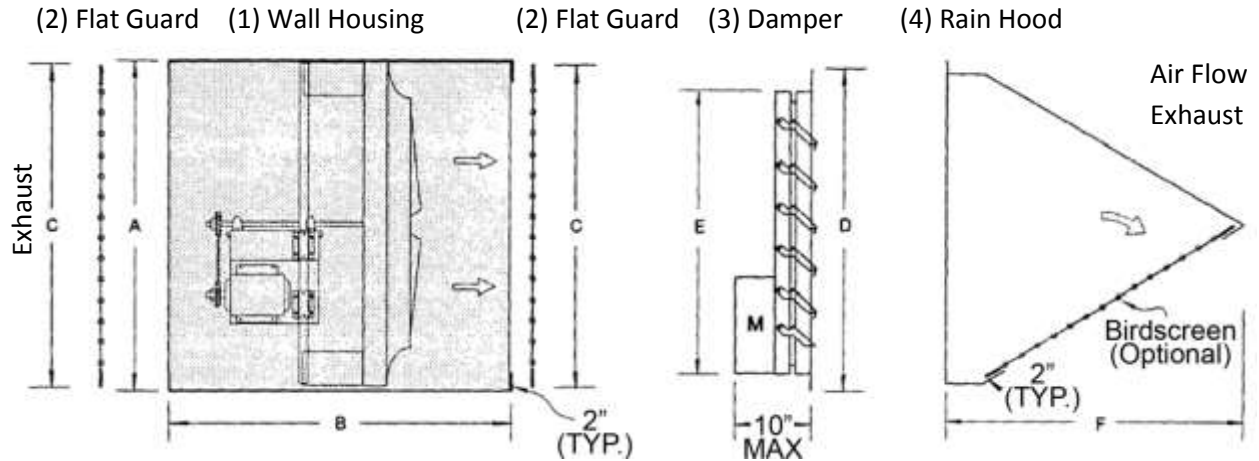

(1) WALL HOUSING		MIN. WALL OPENING (SQ)	FLAT GUARD (2) C (SQ)	DAMPER (3)		RAINHOOD (4) F
FAN SIZE	A (SQ) O.D.			B LENGTH	D (O.D.)	
36	43	43 1/2	42	40 1/2	38	49

NOTE: (1) 44" long wall housing is required

All specifications are subject to change without notice unless approved in submittal by Moffitt