

GulfStream High-Velocity Fan



MoffittCorp.com | (800) 474-3267
1351 13th Ave S. Suite 130
Jacksonville Beach, FL 32250



GulfStream High-Velocity Fan

GulfStream Table of Contents

GulfStream Table of Contents.....	1
GulfStream Product Details	2
GulfStream Submittal Data	3

GulfStream High-Velocity Fan

GulfStream Product Details

PRODUCT DESCRIPTION

Moffitt GulfStream air circulating fans provide an even stream of air around the warehouse or work area. These mounted units are often called "man cooler" cans because they focus a high-velocity jet of air directly on factory personnel. Designed for mounting on either the wall of a building column. Easy to adjust direction. These units are more effective than pedestal fans for cooling a large space and generally take up less floor space as well.

STANDARD FEATURES

- Direct Drive Motor
- High performance zinc-alum propeller.
- Attractive deep spun 14 gauge steel housing.
- Safety guards on inlet and exhaust. 1/2" mesh galvanized steel screen.
- Motor mounting bracket designed to fit most standard off the shelf motors.
- Power cord furnished (single phase only)
- Fan housing coated with a thermally fused powered polyurethane black finish.
- 2 year warranty.

OPTIONAL FEATURES

- Three phase motor
- Oscillators

INDUSTRIAL APPLICATIONS

- | | | |
|------------------|-----------------|---------------------|
| • Warehouses | • Storage Areas | • Garages and Docks |
| • Assembly Areas | • Workshops | • Break Rooms |

GulfStream High-Velocity Fan

GulfStream Submittal Data

GulfStream High-Velocity Fan

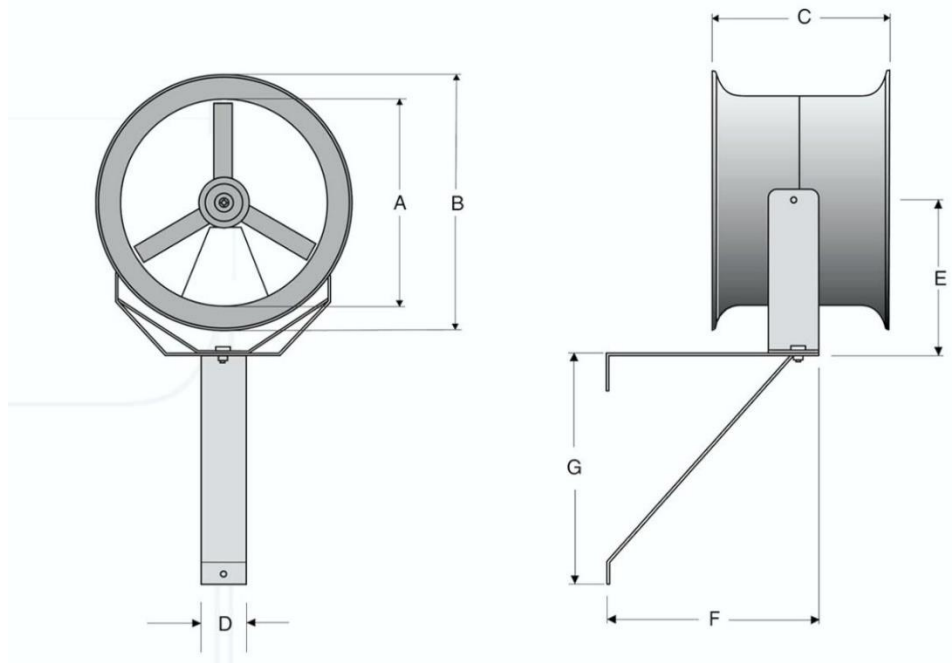

GulfStream High-Velocity Fan



STANDARD FEATURES

- Direct Drive Motor
- High performance zinc-alum propeller.
- Attractive deep spun 14 gauge steel housing.
- Safety guards on inlet and exhaust. 1/2" mesh galvanized steel screen.
- Motor mounting bracket designed to fit most standard off the shelf motors.
- Power cord furnished (single phase only)
- Fan housing coated with a thermally fused powder polyurethane black finish.
- 2 year warranty.

GulfStream High-Velocity Fan

SIZE MODEL	CFM	RPM	HP	AREA COVERAGE (SQ. FT)	DISTANCE AIR THROW (FT)	A	B	C	D	E	F	G	SHIP WEIGHT
AF-CW-14	2690	1725	¼	1800	60	14 ½	20	16	4	12 ¾	27	27 ¼	61
AF-CW-18	3950	1725	½	2400	80	19	24	16	4	15	27	27 ¼	86
AF-CW-22	5630	1725	½	3600	120	22 ¼	29	16	4	16 ⅝	27	27 ¼	92
AF-CW-30	12050	1725	1	12000	200	30 ½	37	22	4	20 ¾	27	27 ¼	149